

FOR SALE

149± ACRES CHEYENNE CO. CROPLAND

TREMBLY FAMILY, ET AL, SELLERS

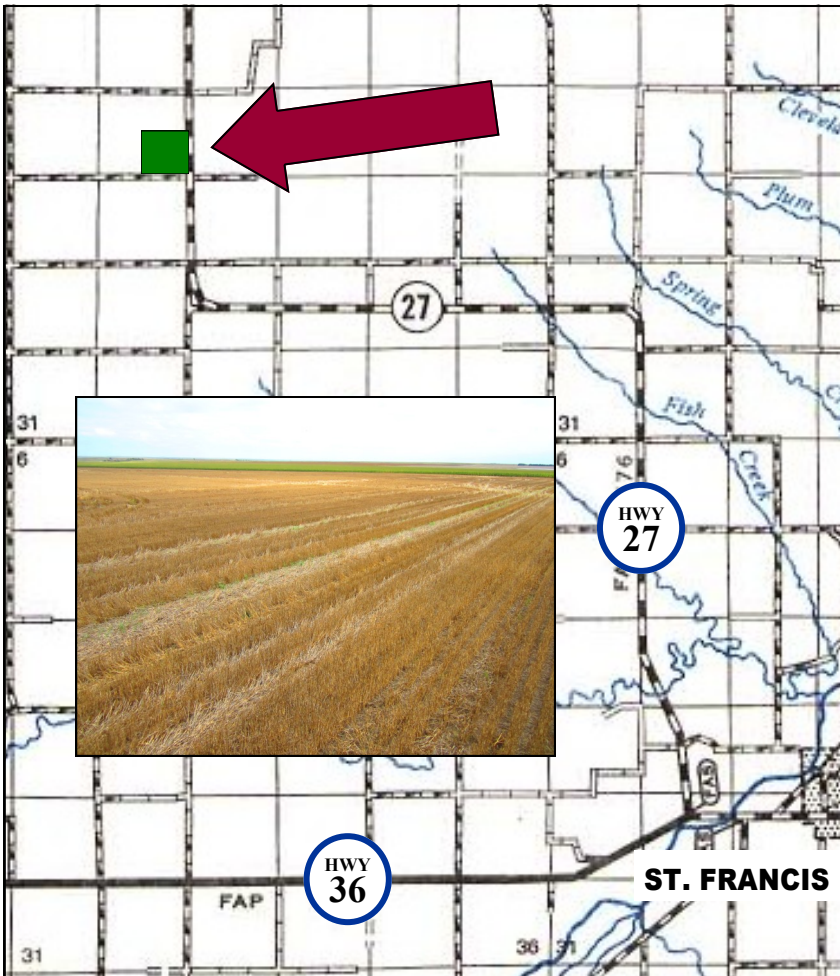

*SE/4 of Section 17, 2-41
Cheyenne Co., KS*

*77.87ac. Wheat Base w/55 bu. Yield
18.98 ac. Corn Base w/121 bu. Yield*

*74.5± Acres planted to corn
74.5± Acres fallow*

2015 Taxes: \$764.56

*Buyer to receive all Seller's
Mineral Interests
including Producing Gas Well*

**Listed Price:
\$290,000**



Reese W. Shay, Broker
970-630-5006 Cell

SHAY REALTY

SERVING KS, CO & NE
800-476-7185 OR 785-332-5656
WWW.SHAYREALTY.COM