

FOR SALE

2 QUARTERS CHEYENNE CO. CROPLAND

NOLAN ESTATE, SELLER

Purchase one or both of these excellent dryland quarters!

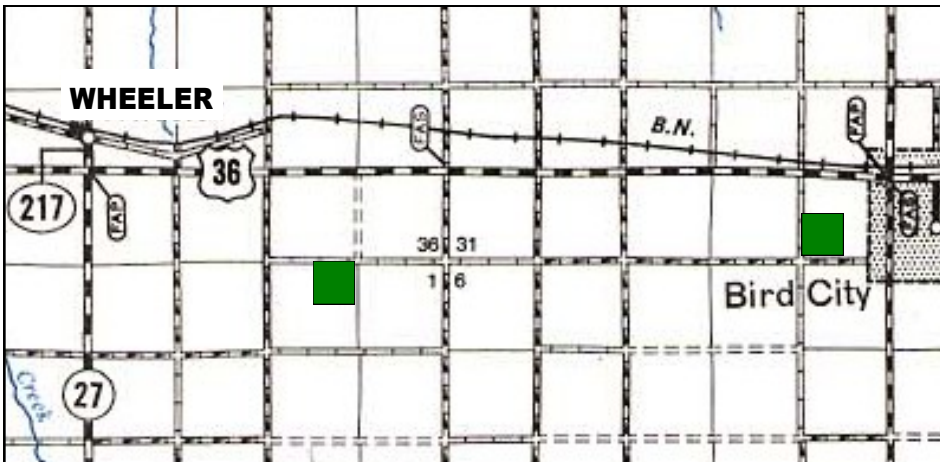

*Seller's share of Growing
Wheat goes to Buyer*

*Seller's Minerals
go to Buyer*

*Approx. 50% Wheat Base
46 bu. Yield
on each Quarter*



NE/4 Sec. 2, 4-39
160± acres in growing wheat
Approx. 2016 Taxes: \$1,064.93
Listed Price: \$2,200/Ac.



144± acres in SW/4 Sec. 35, 3-38
Currently in wheat stubble
Approx. 2016 Taxes: \$981.62
Listed Price: \$2,200/Ac.



Rodney W. Shay
Listing Broker

SHAY REALTY

SERVING KS, CO & NE
785-332-5656 OR 785-332-2566
WWW.SHAYREALTY.COM